

ITEM	DESCRIPTION	DETAIL
1	Upstand flashing	
2	Sheet batten	50x50mm
3	Sticher	35mm
4	Pantile 2000	
5	Membrane	

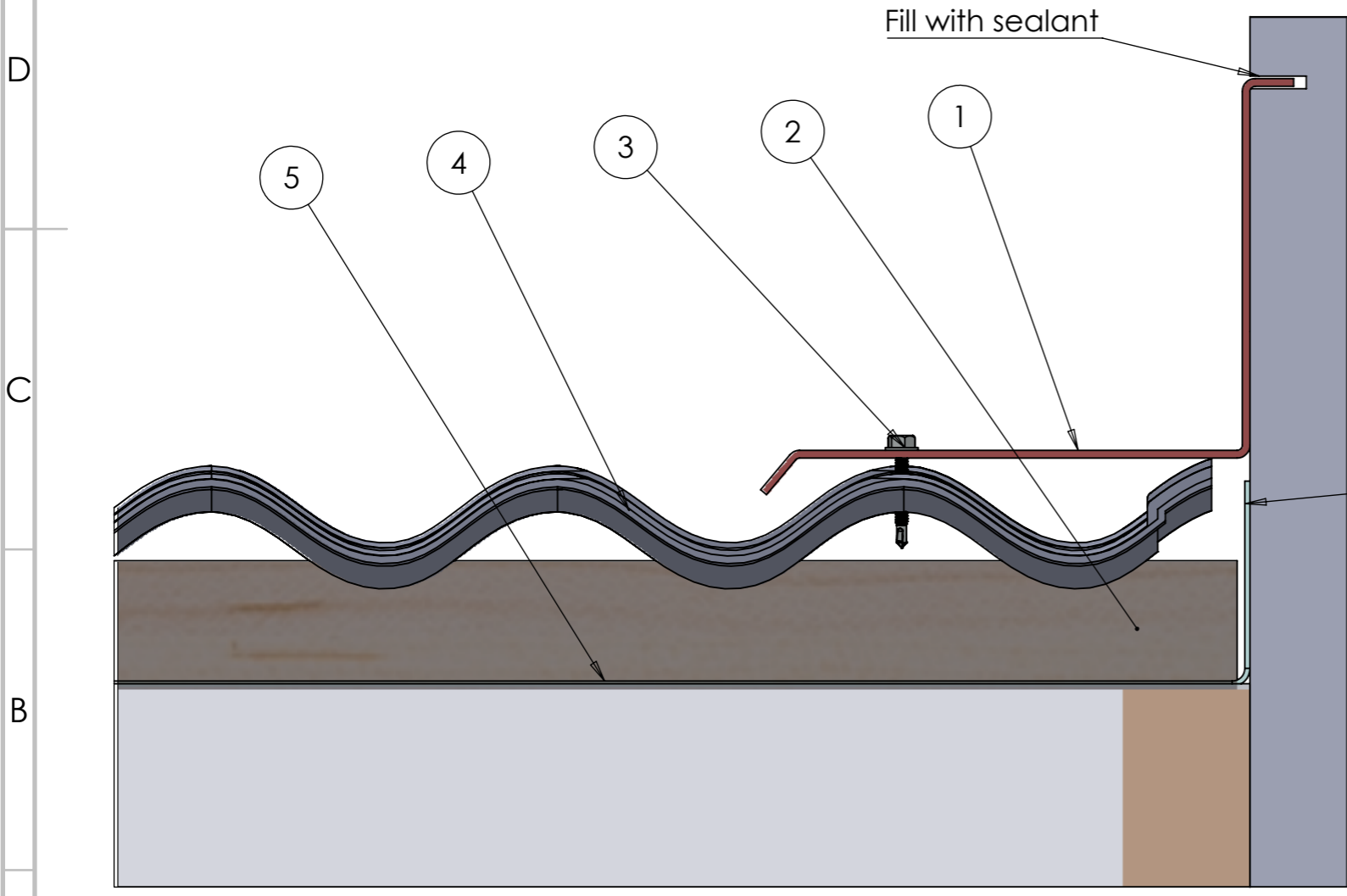
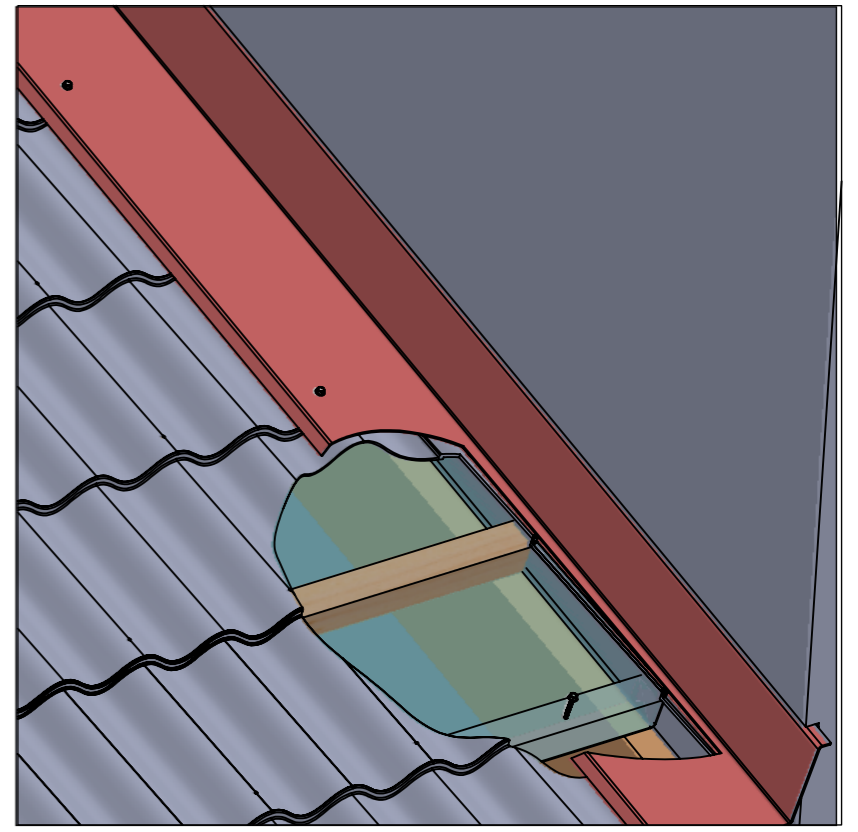

Note - membrane upstand past battens

BRITMET
 LIGHTWEIGHT ROOFING
 Britmet Tileform Ltd
 Kingfisher House, Unit 17
 Overthorpe Road, Banbury, OX16 4SX

DO NOT SCALE DRAWING	REVISION
TITLE: Pantile 2000 Typ. sidewall detail.	
DWG NO. P2-SWall-001-A	
SCALE:DNS	SHEET 1 OF 1

NAME	DATE	MATERIAL:
DRAWN		
CHK'D		

A3